

AMENDMENTS		
NO.	DESCRIPTION	DATE

PROJECT
Media lab

ADDRESS
**Arts Lecture Theatre
UTAS - Sandy Bay**

CLIENT
**University of
Tasmania**

DRAWING
**Level 1 - Demolition
& Floor Plan**

DRAWING NO.
0649 D201

DO NOT SCALE DRAWING
© M2architecture. Unauthorised copying prohibited

DATE
24-11-06 SCALE
1:100

JOB NO.
0649 CHECK

SET NO. SHEET NO.

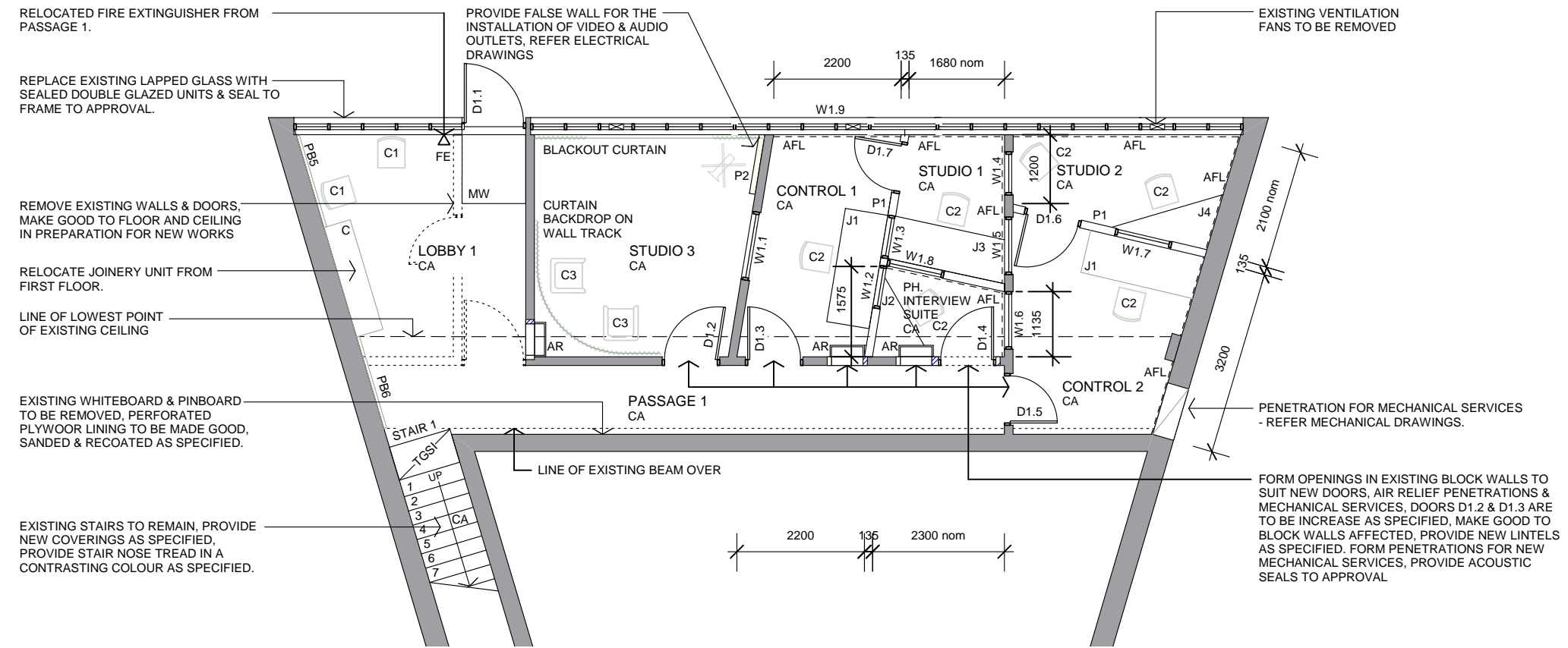

KEY:

- MW SELECTED MAT IN RECESSED ANGLE FRAME AS SPECIFIED
- CA CARPET TILES AS SPECIFIED
- TGSI TACTILE GROUND SURFACE INDICATORS AS REQUIRED BY AS 1428.4
- HR HANDRAILS AS REQUIRED BY AS 1428.2
- P1 CONSTRUCT TO DETAIL, FRAME FROM FLOOR TO UNDERSIDE OF RAKED CONCRETE SOFFIT. TRIM EXISTING CEILING TO SUIT. PROVIDE RESILIENT ISOLATION STRIPS BETWEEN TOP & BOTTOM PLATES & SUBSTRATES. INSULATE SNUGGLY BETWEEN FRAMING USING BRADFORD PINK SONOBATTS 75mm BATTS INNER LINING - 6MM CEMENT SHEET MOUNTED OVER RESILIENT ISOLATION STRIPS, FLUSH JOINTED. OUTER LINING - 13MM FLUSH PLASTERBOARD MOUNTED OVER RESILIENT ISOLATION STRIPS AT EACH FIXING. PAINT FINISH AS SPECIFIED.
- P2 TIMBER STUD FULL HEIGHT FALSE WALL, PLY PANEL LINED
- WB WHITEBOARD AS SPECIFIED.
- AFL ACOUSTIC FOAM TILES AS SPECIFIED. 1800 HIGH TILES TO BE FROM WINDOW HEAD HEIGHT DOWN, MADE UP OF 300x300 & 600x600 TILES AS SPECIFIED.

NOTE:

- EXISTING INTERNAL FACE BRICK WORK & TIMBER WALL PANELLING TO REMAIN, MAKE GOOD AS REQUIRED.
- ALL PAINTED SURFACES TO BE REPAINTED AS SPECIFIED.
- PROVIDE NEW MILD STEEL ANGLE LINTELS AS SPECIFIED TO THE FOLLOWING OPENINGS:
W1.1, W1.4, W1.5, W1.6 & D1.4

t 03 6234 3307
f 03 6234 3192
www.m2a.com.au
228 Murray St
Hobart, 7000
PO Box 114
North Hobart, 7002
abn. 300474080443
Menzies & Marshall Pty Ltd trading as m2architecture

